

KINGSBOROUGH



Greening the Food Program at Kingsborough Community College

Jonathan Deutsch, Ph.D.

Babette Audant, MPA

Context

- About KCC
- Faculty-driven process
- Green jobs?
- Dark green/Light green



Familiar Trajectory

1946- late seventies. Skills-based, union jobs.
(ACF)

Eighties. Add business/management
competencies. (MarkEd)

Nineties. Add service. (NRA)

00s. Add soft skills and entrepreneurship
(NACCE)

10s Add green. (GRA)

Building a Sustainable Food Program at KCC

- Greening Curriculum for Existing Students
(done)
- Modeling Best Practices for Industry (in
process)
- Creating Green Jobs and an Alternative Urban
Food System (grand plan)

Greening Curriculum for Existing Students

- Growing/harvesting and preparing food (garden).
- Local food sourcing and processing (kitchen)
- Green kitchen design and layout
- Green food business incubation (incubator)
- Culinary curriculum shift

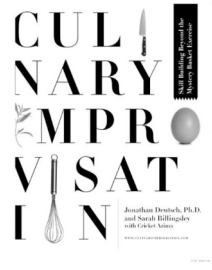

Modeling Best Practices for Industry

- Green Seal certification.
- Additional vendors—farm to chef.
- New purchasing procedures
- Composting
- Recycling
- French Fry Boat
- Students work in model kitchen
- Classes/visits from industry
- Certifying students as auditors



Creating Green Jobs and an Alternative Urban Food System

- Rooftop farm. Jobs: farmers, educators
- Food processing facility Jobs: entrepreneurs, food mfg, wholesaling/brokering, foraging, trucking
- Retailing Jobs: retailing, community nutrition

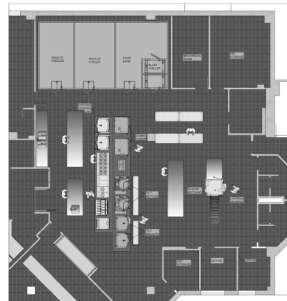

Creating Green Jobs and an Alternative Urban Food System

- Using existing college resources
- Consistent with University-wide sustainability initiatives
- Consistent with municipal initiatives to increase access to healthy foods and revitalize NYC's food production/food system

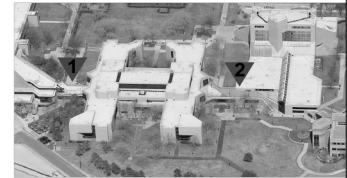

PROPOSED ROOF 1:
Area: 1,546 sqft
Type: Membrane

PROPOSED ROOF 2:
Area: 5,385 sqft
Type: Membrane

NOTE:

KINGSBOROUGH COMMUNITY COLLEGE HAS MORE THAN 450,000 SQ FEET OF FLAT ROOFS OVER 8 MAJOR BUILDINGS. AS PER SURVEY RECENTLY PERFORMED, IN ORDER TO DETERMINE BEST LOCATION FOR GREEN ROOF APPLICATION, THIS LOCATION CAN BE CONVERTED IMMEDIATELY WITH MINOR CHANGES. ROOFS OVER LINKS U BUILDING - WAC AND WAC-LIBRARY. PRIOR TO ANY FUTURE DEVELOPMENT SELECTED ROOFS MUST BE EVALUATED FOR ADDITIONAL LOADS BY PROFESSIONAL CIVIL ENGINEER.

Challenges

Who pays for green (food cost; construction)?

Greenwashing versus commitment

Proliferation of BS certifications

- Abundant info at cewd.net
- jdeutsch@kingsborough.edu
- baudant@kingsborough.edu